



## PME Folding Right/Left Foot Accelerator Pedal

- 1) This operation should only be performed when the vehicles motor is not running.
- 2) Fold up the vehicles original right foot accelerator pedal. There are several small notches that can be felt while folding up the pedal, this is normal. Fold up the pedal until it reaches it's stop and it will not pivot any further.
- 2) Fold down the additional Left Foot Accelerator pedal until it is fully lowered. You will feel some small notches as the pedal is folding down, this is normal.
- 3) Before starting the vehicle depress the Left Foot Accelerator to confirm it is operating correctly.

### **WARNING:**

**It is imperative that during routine maintenance or whenever your vehicle is operated by a driver who is not endorsed to use this adaptive technology; that the standard Right Foot pedal is returned to its original position and the Left Foot Accelerator is folded in the stowed position.**

PME can not be held responsible for any damages or injury caused by the incorrect use of the PME Left Foot Accelerator. Please ensure your license is endorsed for use of this adaptive device if you are unsure contact your local motoring authority.

PME Recommend periodic maintenance and visual inspection of the Left Foot Accelerator at 6 monthly intervals

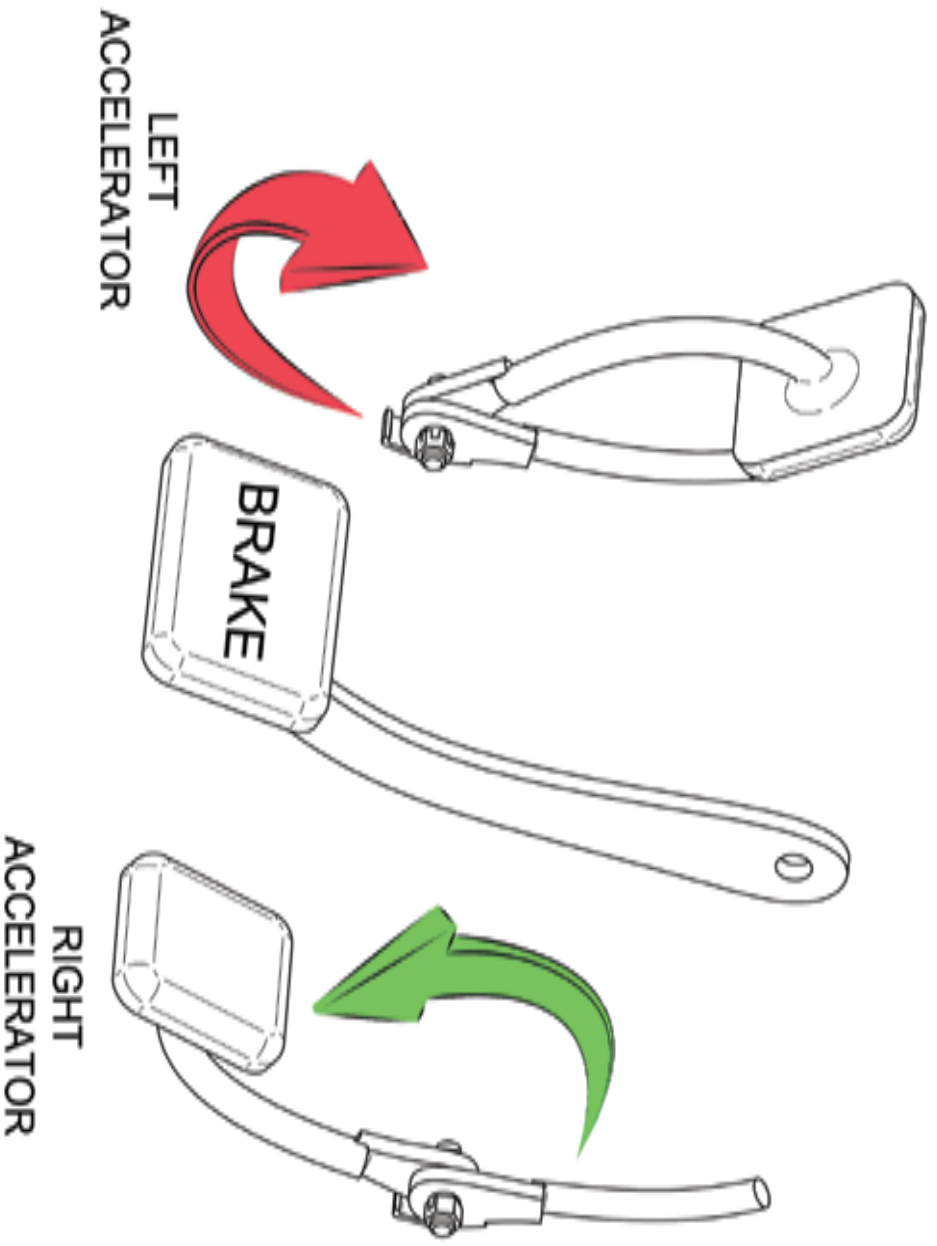

Allways ensure that only one pedal is folded down at any one time.

